

16/15
21/22

2-22-84
H.W.

(47)

Witness Tie to Brass to the West
B.S. Pt. # 210 & RT = $S^{\circ} 23' 04''$
DIST TO WIT. MON = 121.58'

D.B.T.W.D.L. 2-26-85

16/15
21/22
Weber Co.
1963

3600 S



Shiners IN
PWR Pole &
Fence Posts

3500 S

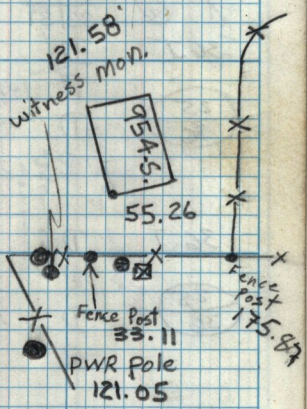

12th So.